



Setting the scene: the VLT in (2001, 2011 and) 2016

F. Delplancke



THE VILLAGE 2024





The VLTi in 2001 and today





The VLTI in 2001 and today





The VLTI before 2001 and today

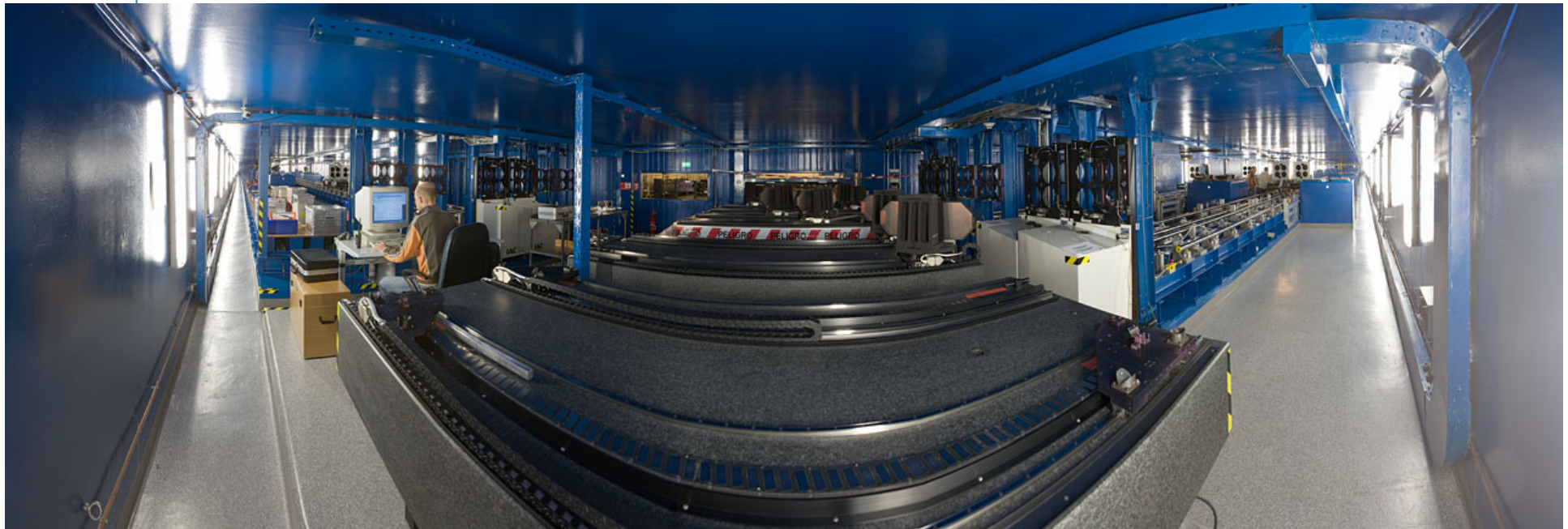

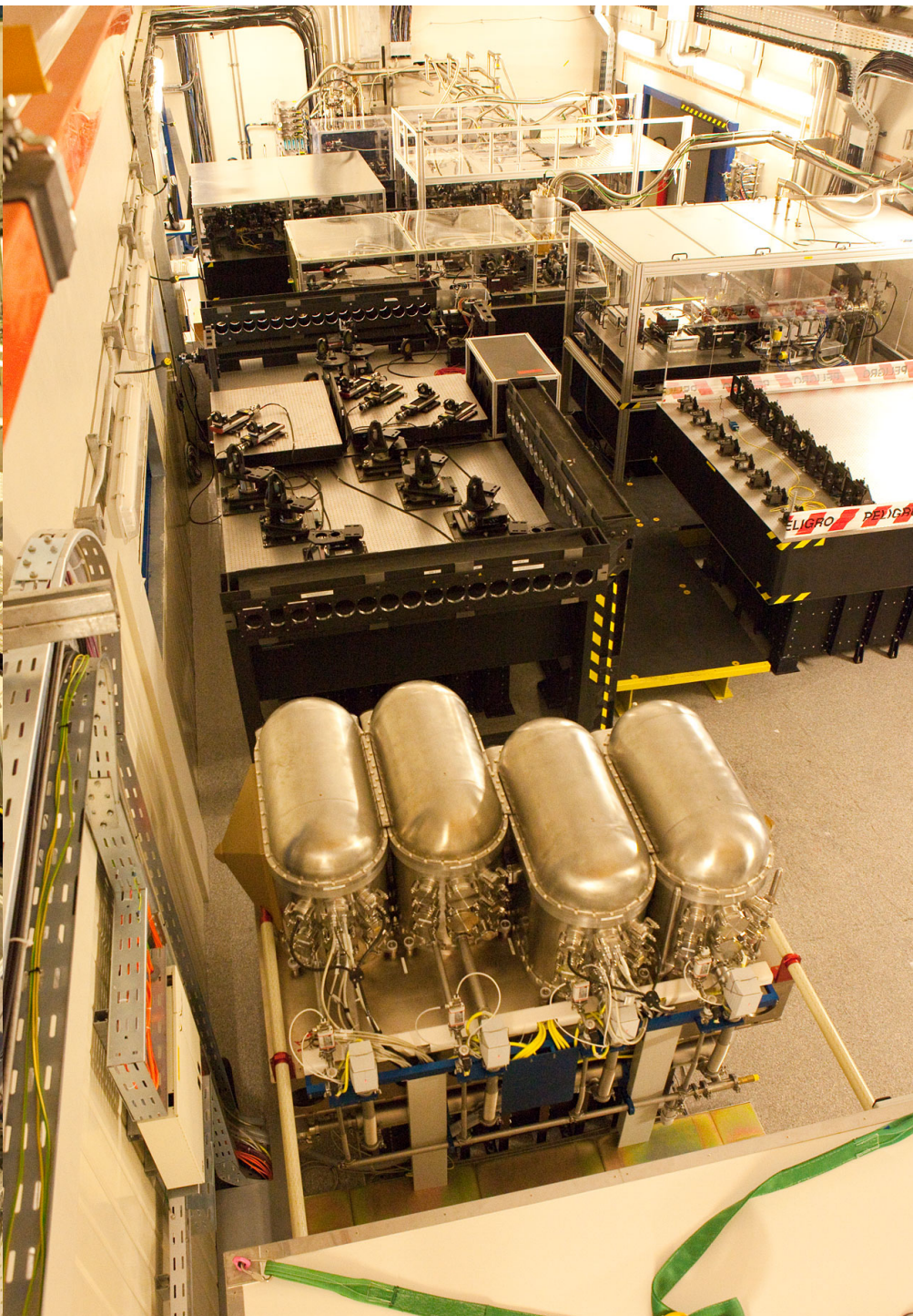
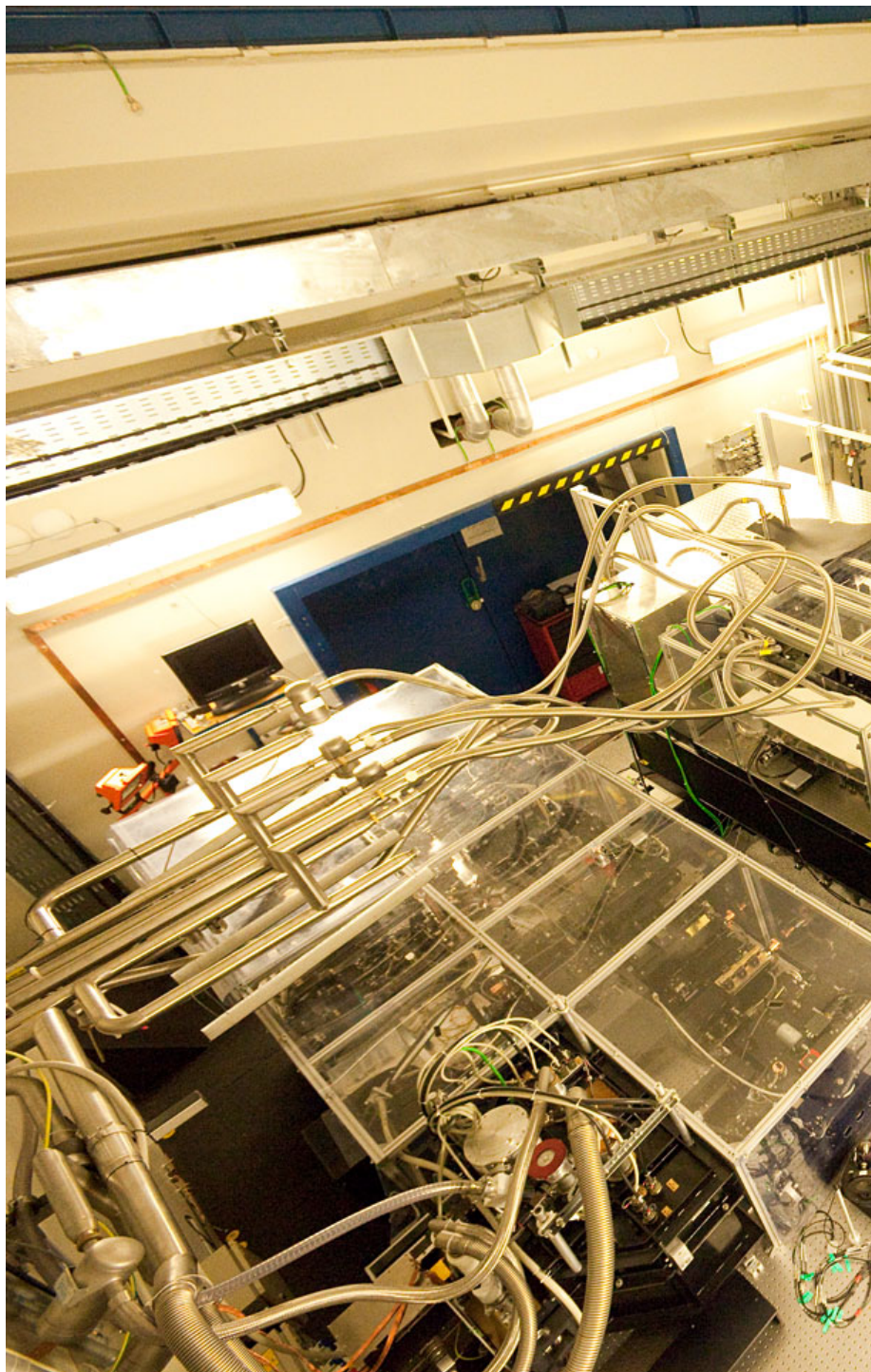



VLTI in 2001 and today





VLTI in 2001 and today

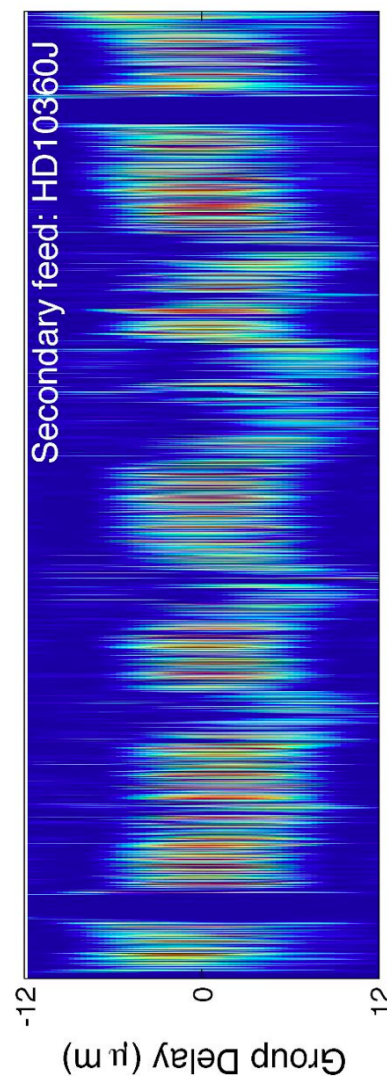
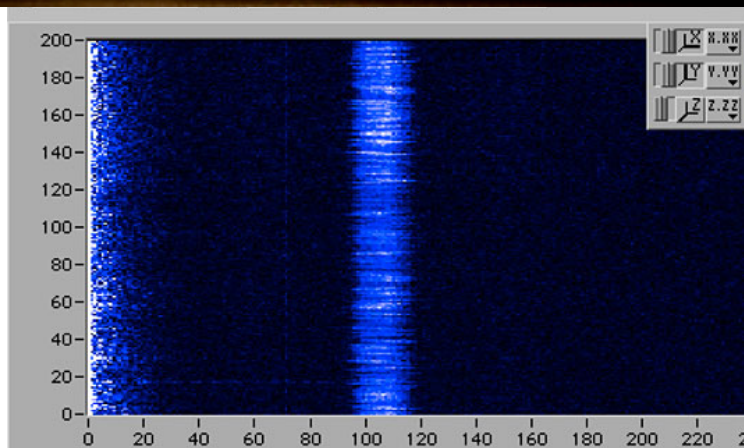
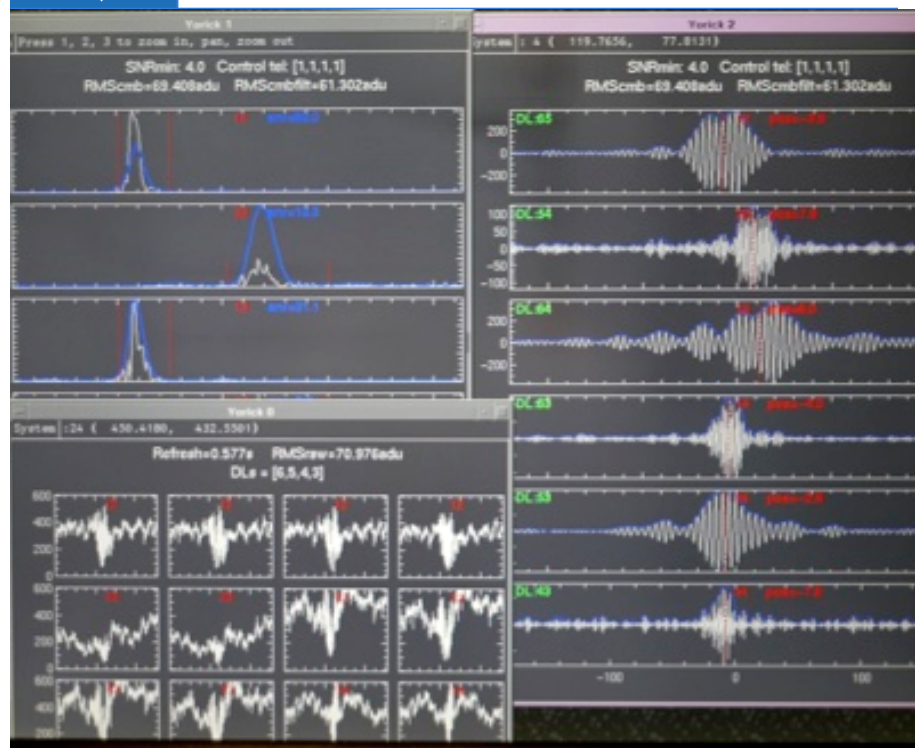



The VLTI Laboratory today

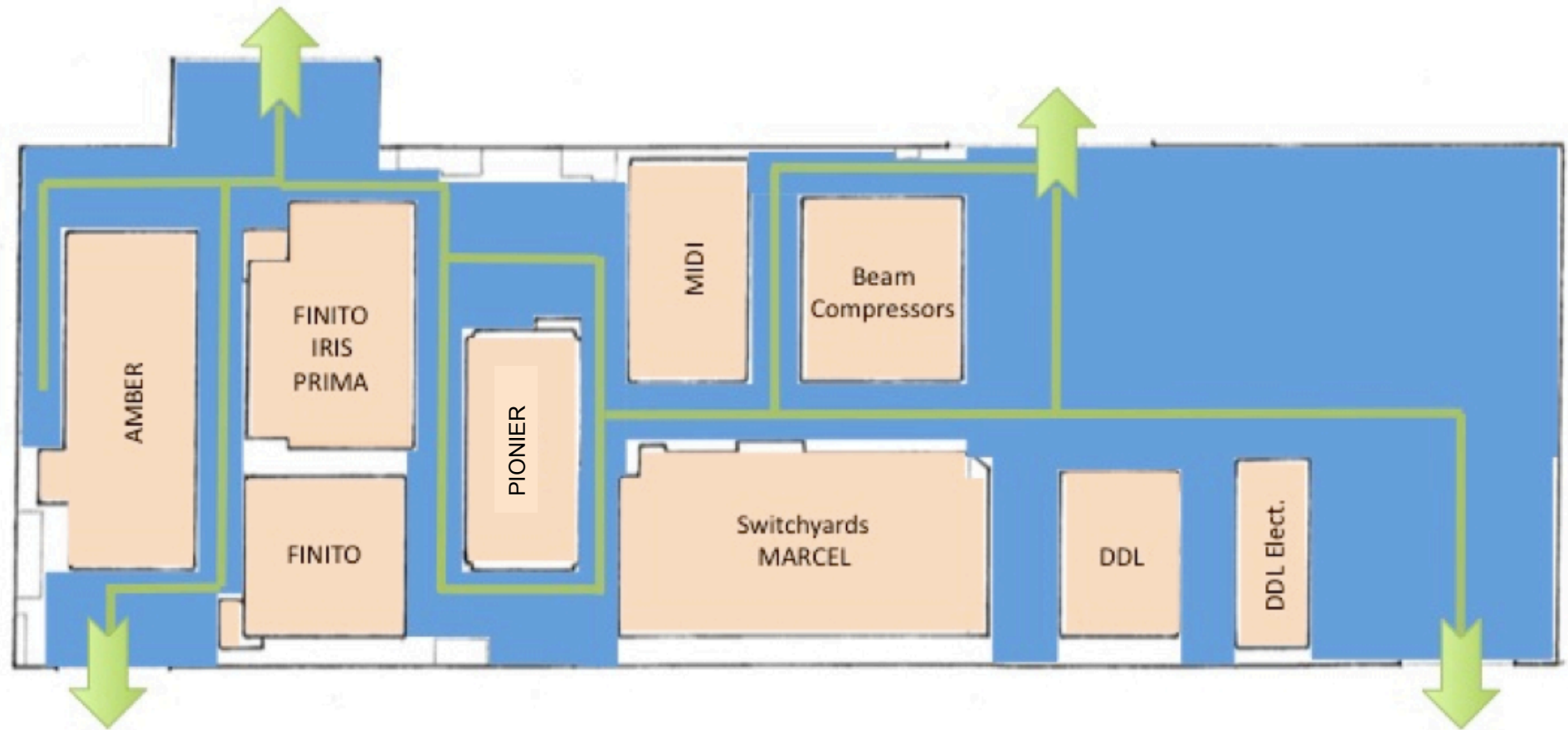



The VLTI Laboratory in 2016

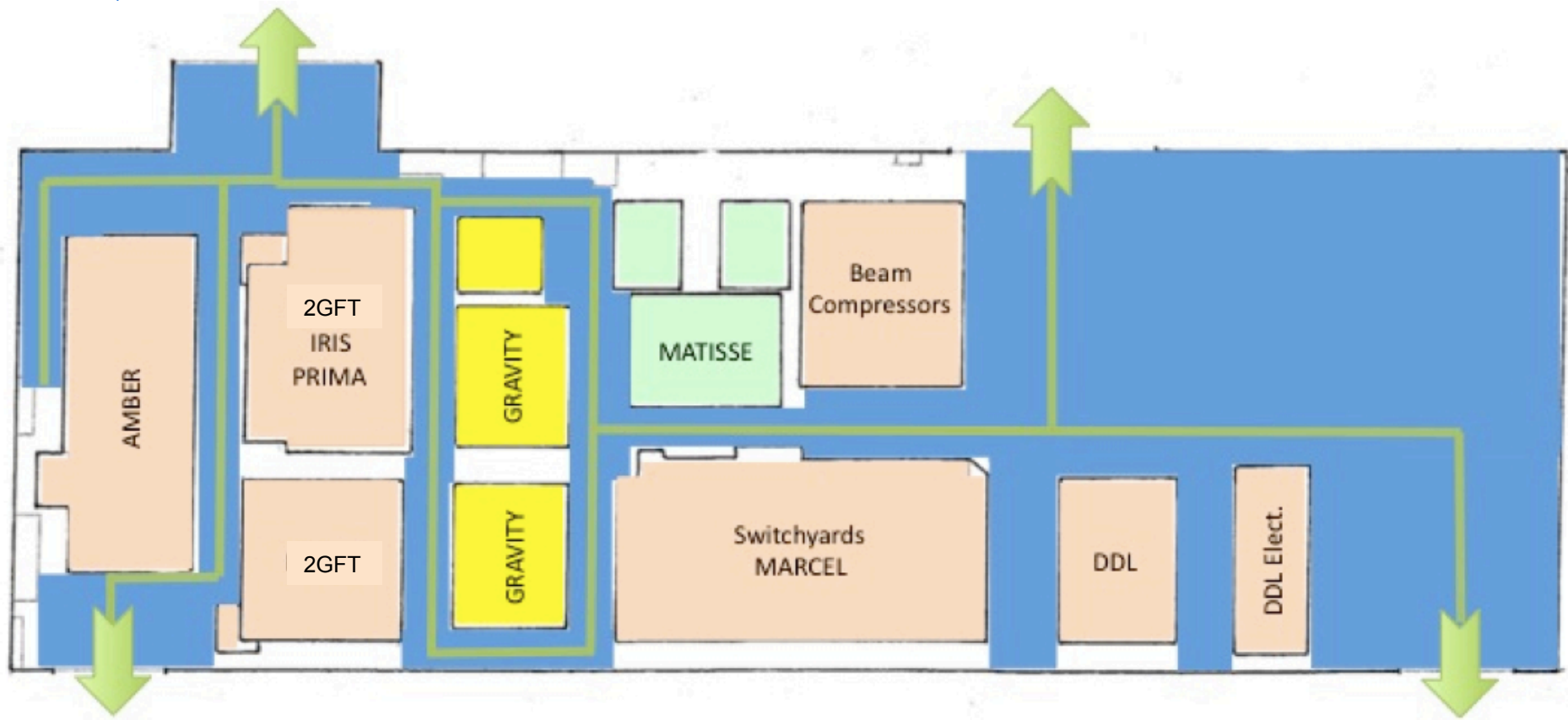



The VLT in 2016

- 4 UTs with MACAO adaptive optics, hopefully “**limited vibrations**” (~250-300nm rms per baseline), with or without **dual-feed** (PRIMA)
- 4 ATs with **NAOMI adaptive optics** (diffraction limited images also with bad seeing down to J-H-bands), with or without **dual-feed** (PRIMA)
- **Matisse**: 4 telescopes, L-N bands, imaging
- **Gravity**: 4 telescopes, K band, astrometry & imaging
- AMBER: 3 telescopes, J-H-K bands
- PACMAN: 2 telescopes, astrometry, K band
- **DDLs** for off-axis 4 telescopes
- **off-axis fringe tracker for 4 beams**
- IRIS for 4 on-axis beams + **IRIS2 for 4 off-axis beams**
- **PIONIER++ ??**



The VLTI in 2025 ??

